

SECTION 00 91 13
ADDENDUM NO. 1

NOTICE is hereby given that the Bidding Documents have been modified and replacement pages issued herewith. Replacement pages have an Issue Date of November 24, 2020, note "Rev. 01" in the header, and indicate text changes for additions by ***bold italic*** and deletions by ~~Strikeout~~.

Replacement pages included for the following sections:

- 00 01 10 Table of Contents
- 01 11 00 Summary of Work (*Page 3 only*)

Contract Drawings included:

- FLWAUWS300D, Rev. 0

Issued by:

Patterson and Dewar Engineers, Inc.



P. Anthony Hanson, P.E.
Electrical Engineer
FL PE License #82804

**SECTION 00 01 10
TABLE OF CONTENTS**

<u>SECTION</u>	<u>DESCRIPTION</u>
DIVISION 00	CONTRACTING REQUIREMENTS
00 01 07	Seals Page
00 01 15	List of Drawings
00 11 16	Invitation to Bid
00 21 13	Instructions to Bidders
00 41 13	Bid Form
00 43 13	Bid Bond
00 43 33	Proposed Products and Suppliers Form
00 43 36	Proposed Subcontractors Form
00 43 73	Proposed Schedule of Values Form
00 45 05	Proposed Exceptions and Deviations
00 45 13	Bidder's Qualifications
00 51 00	Notice of Award
00 52 13	Agreement Form (Stipulated Price)
00 55 00	Notice to Proceed
00 61 13.13	Performance Bond Form
00 61 13.16	Payment Bond Form
00 62 11	Submittal Transmittal Form
00 62 76	Application for Payment Form
00 63 13	Request for Interpretation/Information
00 63 63	Change Order Form
00 72 00	Standard General Conditions (EJCDC C-700, 2013)
00 73 00	Supplementary Conditions (EJCDC C-800, 2013)
00 91 13	Addenda
DIVISION 01	GENERAL REQUIREMENTS
01 11 00	Summary of Work
01 20 00	Price and Payment Procedures
01 31 00	Project Management and Coordination
01 33 00	Submittal Procedures
01 44 00	Quality Requirements
	Attachment A - Independent Materials Testing Services
01 45 29	Testing Laboratory Services
01 77 00	Closeout Procedures
DIVISION 03	CONCRETE
03 30 00	Cast-In-Place Concrete

<u>SECTION</u>	<u>DESCRIPTION</u>
DIVISION 27	COMMUNICATIONS
27 13 00	Communications Cabling
DIVISION 31	EARTHWORK
31 23 35	Excavation, Trenching and Backfilling
DIVISION 32	EXTERIOR IMPROVEMENTS
32 15 40	Crushed Stone Surfacing
DIVISION 33	UTILITIES
33 44 19	Oil Containment System
33 72 10	Substation Steel Structures
33 72 20	Substation Structures Erection
33 72 25	Substation Equipment
33 72 40	Conduit and Junction Boxes
33 72 43	Substation Control Wiring - 600 VAC
33 72 50	Substation Construction
33 79 23	Substation Grounding

ATTACHMENTS

Exhibit A – STD003 – Standard Conductor Labeling
 Exhibit B – Existing Equipment Pictures

REVISION HISTORY

Revision No.	Date	Description
00	11/05/2020	Issued for bid
01	11/24/2020	Issued Addendum No. 1

END OF SECTION 00 01 10

- J. Provide weather protection, including temporary heat, electric power, plastic coverings, or other items required for the protection of materials for installation, or being installed on site, until the Contract Work is accepted by Owner.
- K. Furnish and erect or install any staging, shoring, bracing, temporary steel and any falsework of any character, whatsoever, necessary for the erection of Contractor's work. Include any relocation of equipment, and such items shall be furnished, placed, and removed by Contractor.
- L. Provide in the work areas in close proximity to the Work, fire extinguishers of sufficient size and quantity satisfactory to Owner and the local fire department having jurisdiction.
- M. Perform and construct work in accordance with federal, state, and local laws, regulations, and codes, including those regulating the environment.
- N. Obtain and pay for construction permits and licenses.
- O. Conform material, equipment, and services furnished to the accepted standards and practices of the electric utility industry.
- P. Contractor and Contractor's representatives shall wear proper PPE while working within the energized substation. Proper PPE is HRC 2 clothing.

1.05 SITE VISIT

- A. Work stated and specified herein involves construction of pads, foundations, and placement of gravel surfacing. Though Engineer has attempted to depict construction conditions as accurately as possible, Contractor is strongly advised to undertake the following:
 - 1. Visit site prior to submitting a bid for Contract Work.
 - 2. Pay special attention to scheduling Work activities to permit expeditious accomplishment of the requirements.
 - 3. Pay special attention to the requirements necessary to provide proper drainage away from adjacent property and to prevent erosion during construction activities.
- B. Owner will not consider adjustments to the Contract Price after award due to Contractor's failure to recognize the conditions under which Work is to be performed.

1.06 MATERIAL/WORK FURNISHED BY OTHERS

- A. Others will perform the following:
 - 1. Substation final testing and cutover
- B. Items furnished by Owner/Others
 - 1. One 69-12.47 kV transformer with LTC (Offloading and assembly by manufacturer)
 - 2. One 69kV circuit switcher
 - 3. ~~Station service transformers~~

PART 2 -- PROJECTS – NOT USED**PART 3 -- EXECUTION – NOT USED**

END OF SECTION 01 11 00

PLOTTED: 1/18/2020 9:28 AM BY EDURHAM
FILE LOCATION: U:\E\EL\FM\PAWAUCHULASUBS\WAUCHULA SUB\CAD\FLWAUWS3000.DWG

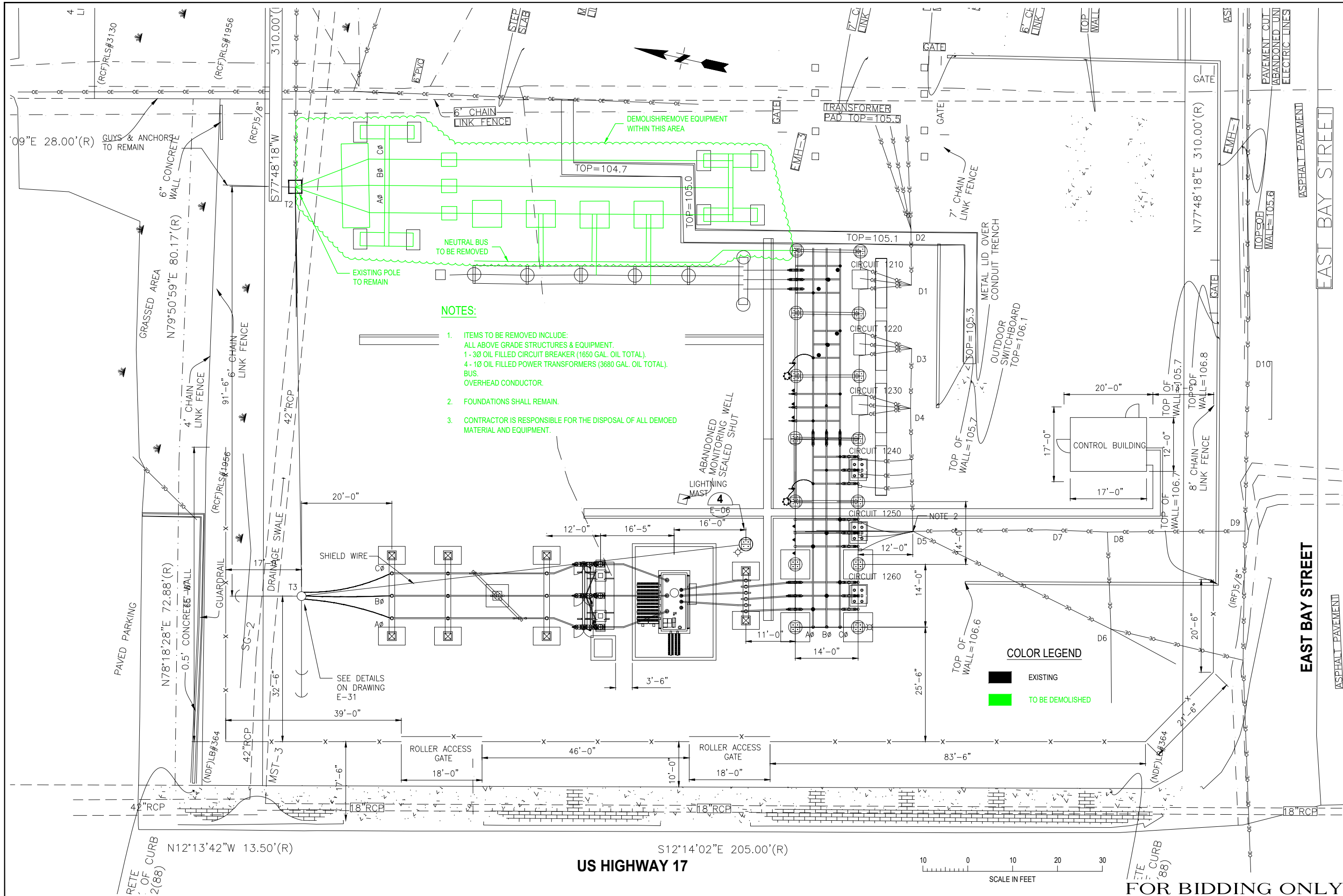

NO.	DATE	REVISION

CITY OF WAUCHULA, FLORIDA
**WAUCHULA SUBSTATION
DEMOLITION PLAN**

**patterson & dewar
ENGINEERS**
850 CENTER WAY, NORCROSS, GEORGIA 30071
(770) 453-1410 | pdengineers.com
ENGINEERS - SURVEYORS

DATE	10-29-20
SCALE	
DRAWING NO.	FLWAUWS3000
REV.	0

FOR BIDDING ONLY

Checked By: PAH
Drawn By: EED
ISSUED FOR BIDS:
0 11-06-20